

# MAGAIN



478 Greenhill Road HAZELWOOD PARK SA

3  1 

Superbly located this is an excellent opportunity to move into this desirable suburb and upgrade to your own taste. Original but very well presented this home comprises separate entrance with attractive polished floorboards, three generous bedrooms, good sized lounge room, formal dining and large front and rear gardens. Situated on a valuable corner allotment of approximately 715sqm with side access to a double carport and garage. Ideal for a family being only a short stroll from Hazelwood and Wood Park.

**Type** : House

**View** : <https://www.magain.com.au/property/478-greenhill-road-hazelwood-park-sa/8435299>

**478 Greenhill Road  
HAZELWOOD PARK**

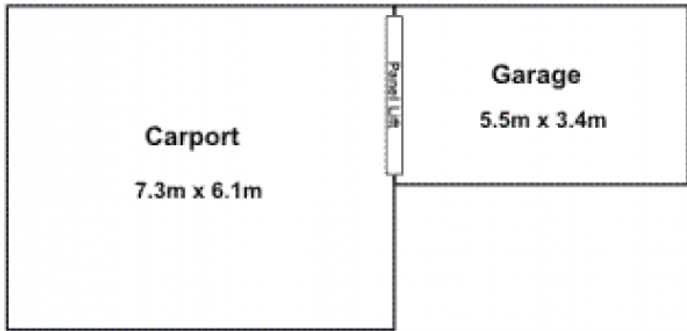
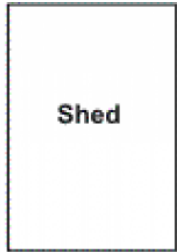

Area	M <sup>2</sup>
Living	155.36
Carport	44.53
Verandah	49.92
<b>Total</b>	<b>249.81</b>

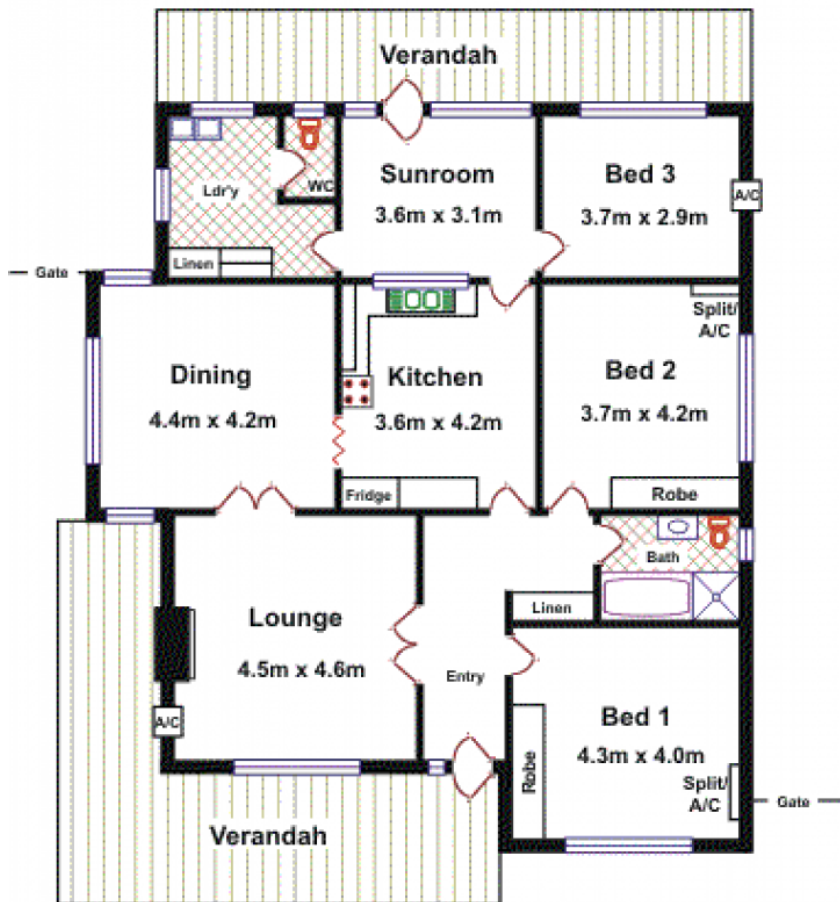

**Please Note:** Every care has been taken to verify the correctness of the areas and details used in this leaflet. However, the plan is not a surveyed plan and the dimensions given are estimates only. No warranty or representation is given or made as to the correctness of the information supplied and neither the owners nor the Agents can accept responsibility for errors or omissions.