

MAGAIN



**2B Guthrie Street, Ovingham (adjacent Bowden)
BOWDEN SA**

3  **1**  **2** 

Superbly presented with generous accommodation this appealing 2 storey home is just a short stroll through the Parklands away from vibrant North Adelaide shopping and cafes.

Comprising 3 bedrooms with built ins, the main with walk in robe, spacious formal living room, large rumpus and casual family meals adjacent the stunning kitchen which features stainless steel Miele appliances and dishwasher.

Other features include zoned ducted reverse cycle air conditioning, attractive bathroom, separate laundry, electric roller shutters and security.

Outside the property offers a large undercover entertaining

Type : House
Land Size : 232 sqm
View : [https://www.magain.com.au/property/2b-guthrie-street,-ovingham-\(adjacent-bowden\)-bowden-sa/8435519](https://www.magain.com.au/property/2b-guthrie-street,-ovingham-(adjacent-bowden)-bowden-sa/8435519)

[For full version visit the website](https://www.magain.com.au)

<https://www.magain.com.au>
Magain Real Estate

457 Greenhill Road Tusmore SA
08 8332 1022

| Area | M ² |
|--------------|----------------|
| Ground Floor | 86.83 |
| Upper Floor | 63.96 |
| Carport | 26.73 |
| Verandah | 10.69 |
| Total | 188.21 |



Upper Floor

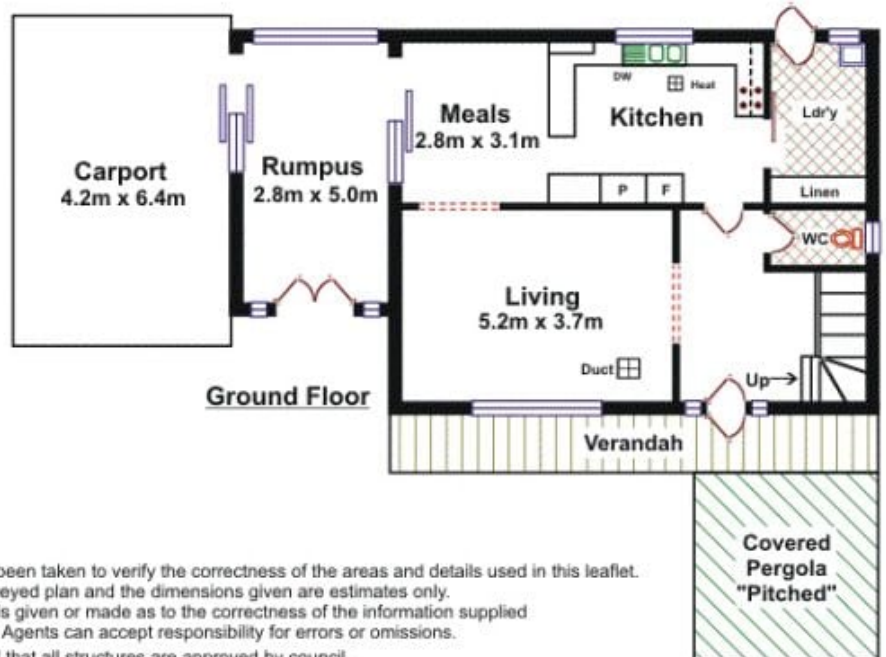
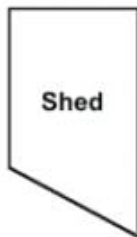

Ground Floor

Please Note: Every care has been taken to verify the correctness of the areas and details used in this leaflet. However, the plan is not a surveyed plan and the dimensions given are estimates only. No warranty or representation is given or made as to the correctness of the information supplied and neither the owners nor the Agents can accept responsibility for errors or omissions. Please check with local council that all structures are approved by council.