

MAGAIN

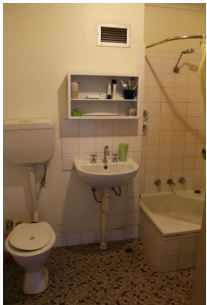

61/2 Ayliffes Road ST MARYS SA

2  1  1 

Well positioned, this secure second floor 2 bedroom unit located within close proximity to Flinders University and Medical Centre plus walking distance to the new Tonsley Technology Hub ticks all the boxes for investors or 1st home buyers.

Currently leased at \$220.00 per week, close to many facilities including Shepherds Hill Recreation Park and easy access to public transport this is a great opportunity for those looking to live in or invest at a modest price.

For further information or to arrange an inspection please contact Matt Scarce or Grace Centofanti on 83321022 or 0412118685.

Property Code: 1358

[For full version visit the website](#)

Type : Unit

View : <https://www.magain.com.au/property/612-ayliffes-road-st-marys-sa/8435724>

Unit 61, 2 Ayliffes Road SAINT MARYS

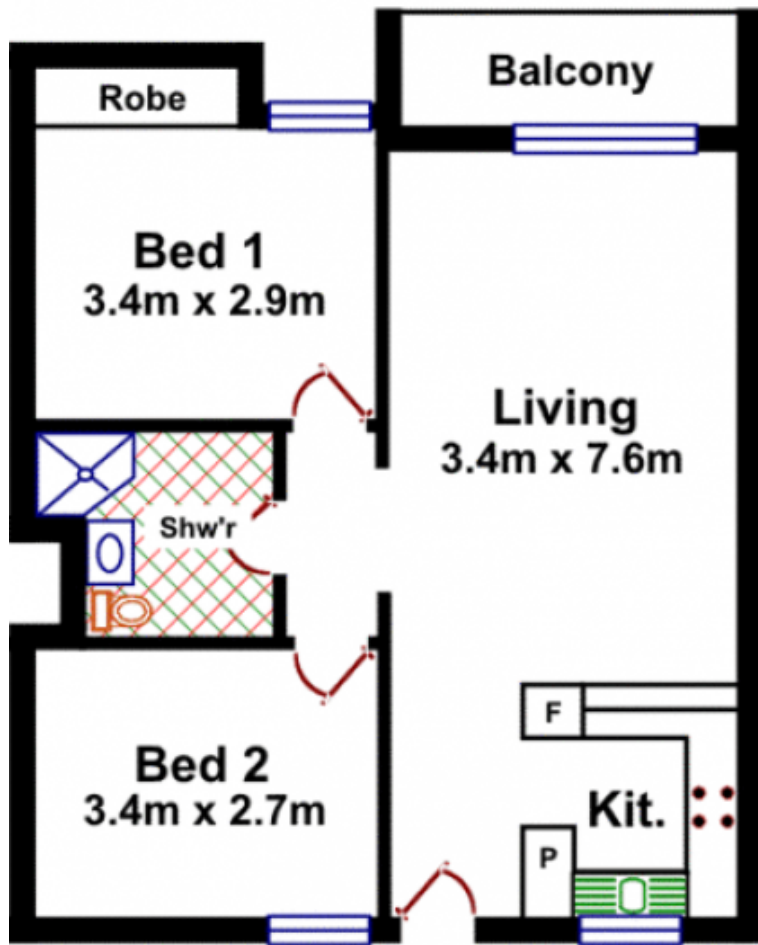

Area	M ²
Living	62.62
Balcony	3.70
Total	66.32