

MAGAIN



32 Rees Street SHEIDOW PARK SA

4 2

The moment you walk through the front door of this immaculate home you will be wowed by the size and luxury on offer. Situated on a quiet street with an above average size allotment of approximately 657sqm the home also offers the bonus of a brand new 6.6KW solar system!

Type : House
Land Size : 657 sqm
View : <https://www.magain.com.au/property/32-rees-street-sheidow-park-sa/8435747>

Comprising a large formal entrance leading into the generous size open plan living area, adjacent dining area with sliding doors integrating well with the outstanding outdoor entertaining area, stunning kitchen upgrade with an abundance of storage, preparation space and stainless steel appliances which include a brand new dishwasher and a 900mm gas cook-top oven. The entry, kitchen and open plan living areas all feature attractive timber floors.

[For full version visit the website](#)

<https://www.magain.com.au>
Magain Real Estate

457 Greenhill Road Tusmore SA
08 8332 1022

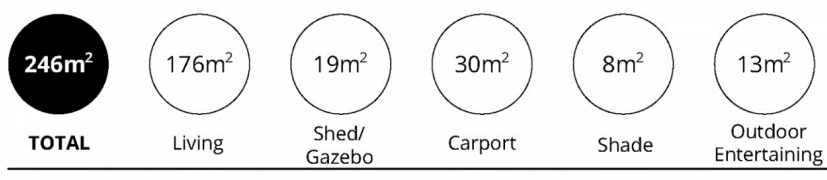
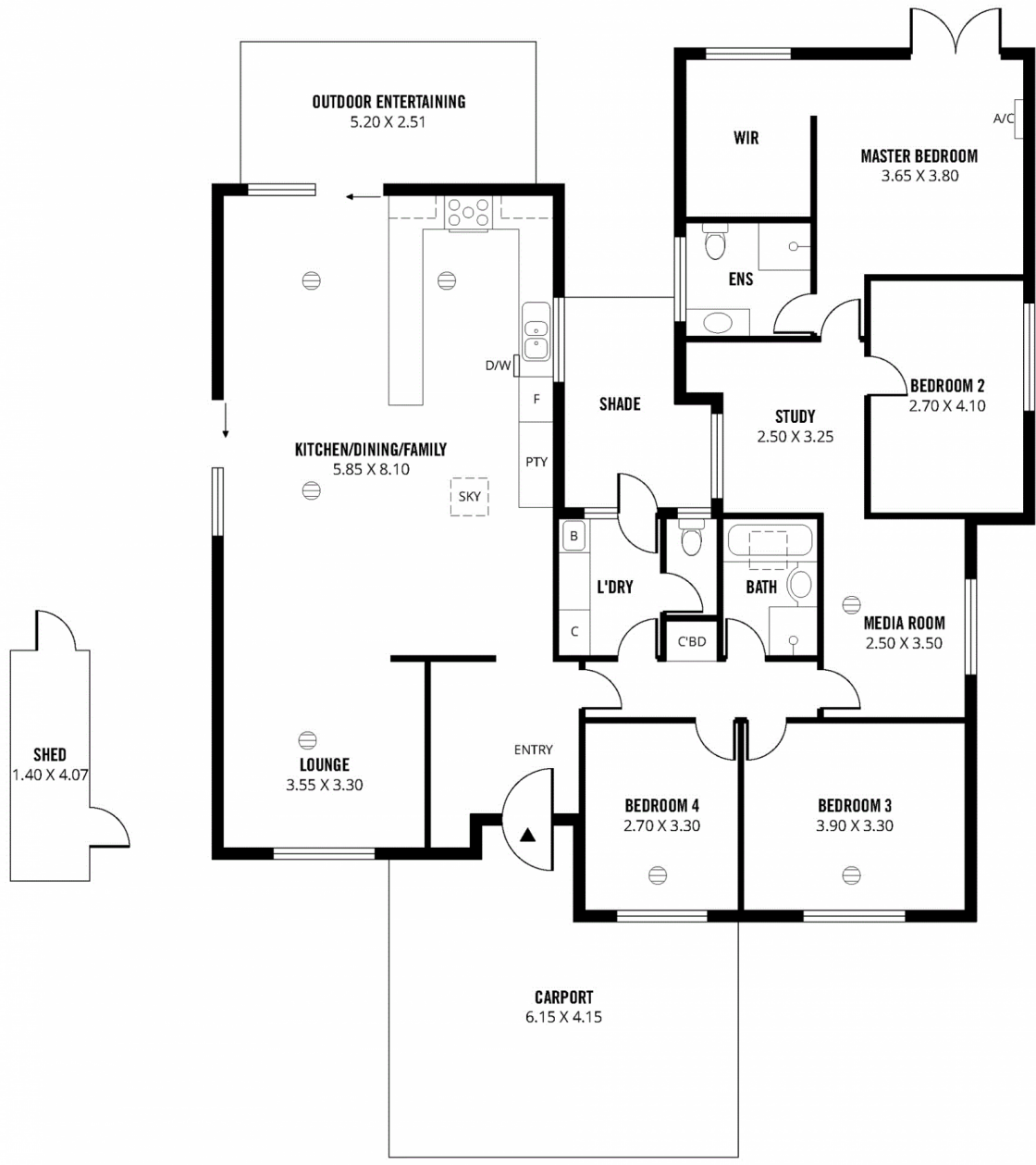
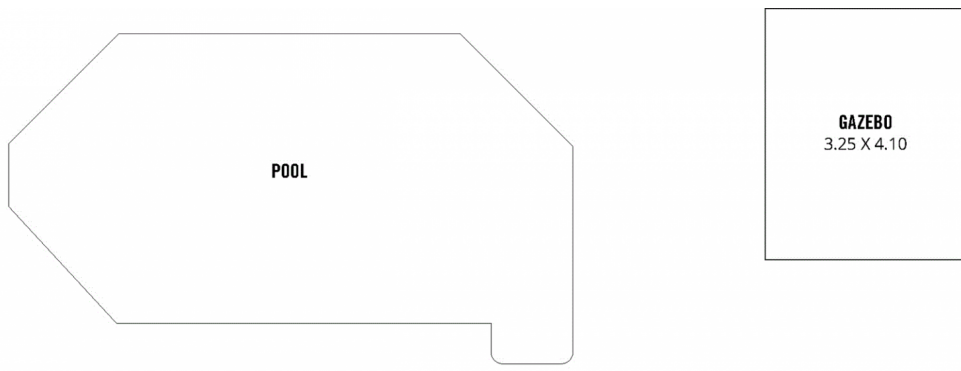

Scale in metres. This drawing is for illustration purposes only. All measurements are approximate and details intended to be relied upon should be independently verified.

Produced by The Fotobase Group