

MAGAIN



22 Wahroonga Avenue WATTLE PARK SA

Sensational allotment of 880 sqm (approx) with two street frontages

Containing an existing 3 bedroom home in need of significant renovation.

Opportunity to demolish and build a home of significant proportions on this large land holding or renovate and extend existing home (subject to the necessary Council consents).

The popular corner location with frontages along Wahroonga and Yeltana avenues represents a range of possible building options.

Type : Land

View : <https://www.magain.com.au/property/22-wahroonga-avenue-wattle-park-sa/8435992>

[For full version visit the website](https://www.magain.com.au)

<https://www.magain.com.au>
Magain Real Estate

457 Greenhill Road Tusmore SA
08 8332 1022

22 Wahroonga Avenue WATTLE PARK

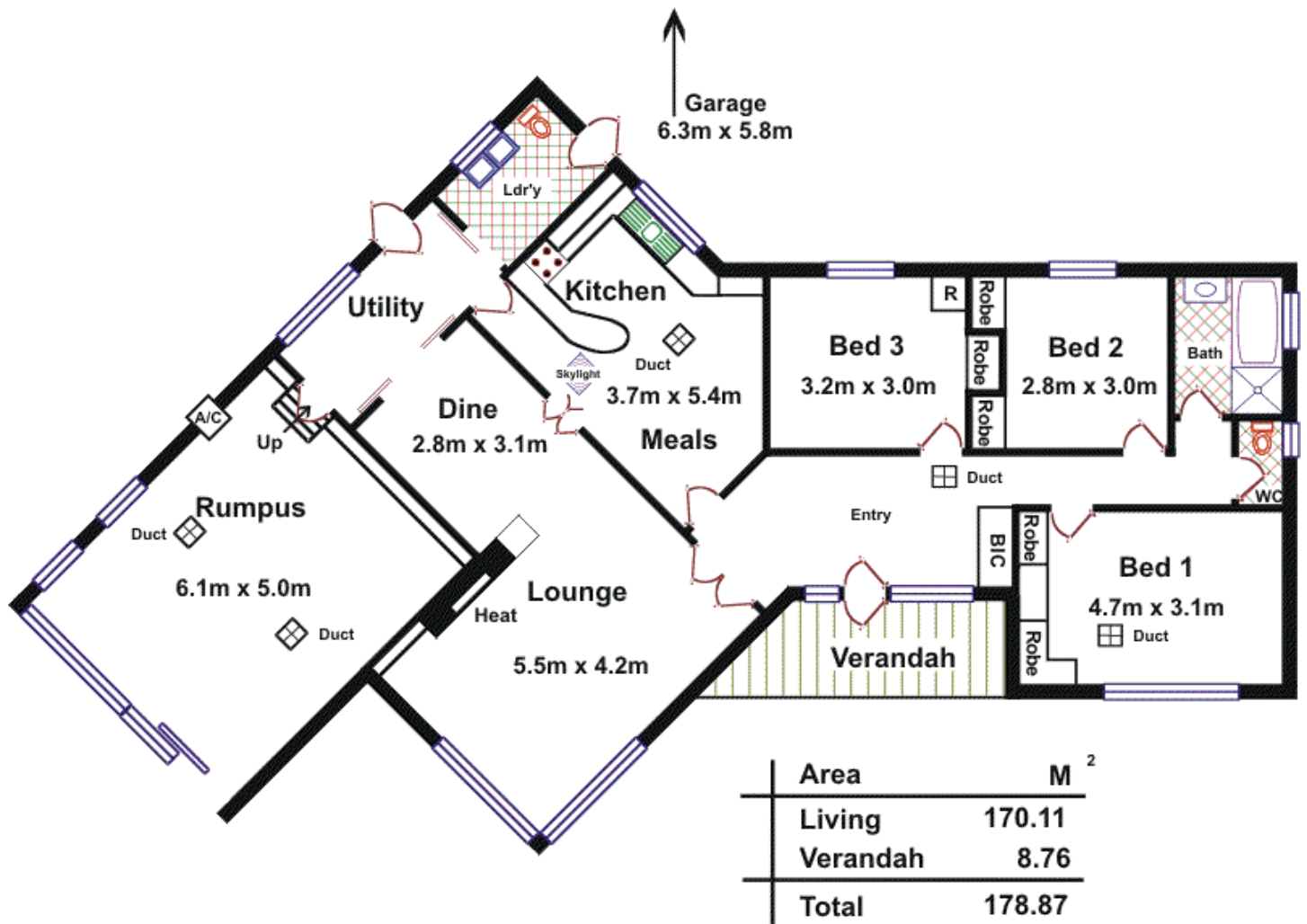

Please Note: Every care has been taken to verify the correctness of the areas and details used in this leaflet. However, the plan is not a surveyed plan and the dimensions given are estimates only. No warranty or representation is given or made as to the correctness of the information supplied and neither the owners nor the Agents can accept responsibility for errors or omissions.