

# MAGAIN



## 25 Emerald Road MORPHETT VALE SA

3 1 2

Please call Mike Dobbin or Zoe Usher for inspection details.

This spacious home is sure to impress any savvy investor or young couples or families looking to get a start in the market. With plenty of space for entertaining with friends & family both inside & out. Located close by to local shops, schools and handy to transport to make busy lives easier.

The spacious floor plan offers three good size bedrooms, all with ceiling fans and built in robes, there are two large living areas, a carpeted family room with ceiling fan and a lounge & dining room with lovely polished timber floorboards. The kitchen has overhead cupboards for added storage plus servery through to the family room. To

[For full version visit the website](https://www.magain.com.au/property/25-emerald-road-morphett-vale-sa/8436282)

**Type** : House  
**Building Size** : 16 sqm  
**Land Size** : 610 sqm  
**View** : <https://www.magain.com.au/property/25-emerald-road-morphett-vale-sa/8436282>



**Zoe Ball**  
08 8381 6000

25 Emerald Road Morphett Vale, South Australia.

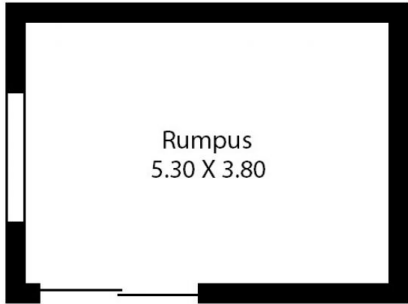
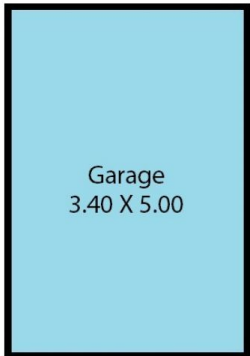

Picture intended as a reference only. Any specific measurements required should be obtained by an independent surveyor.