

MAGAIN



84 Railway Terrace EDWARDSTOWN SA

3  1  1 

Contact Andrew Boswell for further details.

Ideal opportunity for an investment or live in. Take advantage of easy care living and a pivotal location only a minutes walk to the local train station and quick access to the CBD and Flinders Medical Centre. Only four townhouses in this community titled group with frontage onto Railway Terrace and invaluable rear gated access to Robert Street. Perfect access and safe storage for your trailer/pop top caravan. This property has the following features;

- Ground floor with kitchen overlooking meals area and family room at the rear
- Bonus downstairs 2nd toilet and separate laundry
- Split system air con in the family room
- Access to the rear lawned garden and undercover

[For full version visit the website](https://www.magain.com.au/property/84-railway-terrace-edwardstown-sa/8436458)

Type : Townhouse
Building Size : 14 sqm
Land Size : 301 sqm
View : <https://www.magain.com.au/property/84-railway-terrace-edwardstown-sa/8436458>



Andrew Boswell
08 8381 6000

<https://www.magain.com.au>
Magain Real Estate

Shop 15, Woodcroft Market Plaza, 217 Pimpala Road W
08 8381 6000

SHED
2.00 X 3.00



GROUND FLOOR

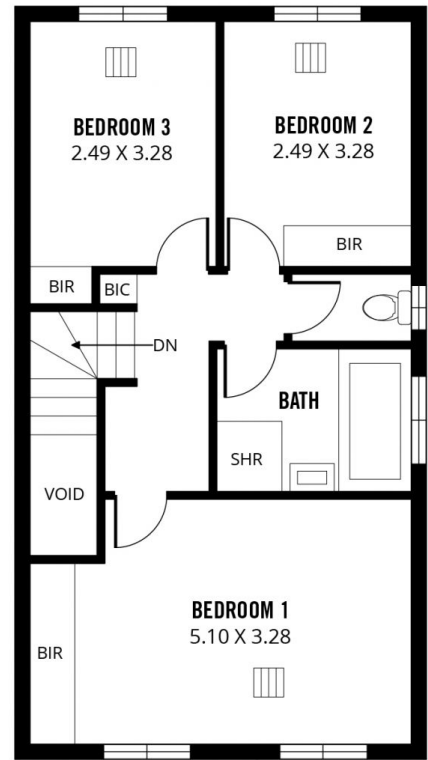

FIRST FLOOR



Scale in metres. This drawing is for illustration purposes only. All measurements are approximate and details intended to be relied upon should be independently verified.

Produced by **The Fotobase Group**