



MAGAIN



6 Alexander Crescent CHRISTIE DOWNS SA

3  1  4 

This meticulously cared for three-bedroom family home on a generous 740sqm corner block with plenty of space and a large shed for the extra cars, boat and/or caravan, is definitely one you must see.

As you enter the home you are immediately in the open plan living, dining and kitchen area. With large windows the surrounding area is filled with beautiful natural light during the day. The kitchen has plenty of bench space and storage and is equip with a stainless-steel dishwasher.

Down the hallway you will find all 3 bedrooms and the main bathroom, the bathroom has a separate toilet and vanity for convenience. The master bedroom and bedroom 2 have built in robes with bedroom 3 having plenty of room to

Type : House
Land Size : 740 sqm
View : <https://www.magain.com.au/property/6-alexander-crescent-christie-downs-sa/8436597>



Scott McPharlin
08 8382 0029

[For full version visit the website](https://www.magain.com.au)

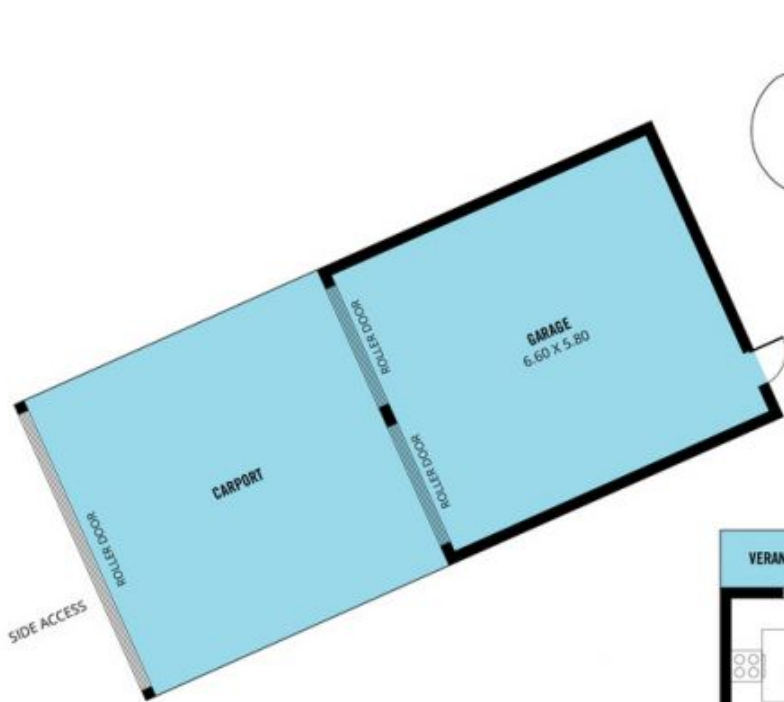

Scale in metres. This drawing is for illustration purposes only. All measurements are approximate and details intended to be relied upon should be independently verified.

Produced by The Fotobase Group