

# MAGAIN



43 Idlewild Avenue ABERFOYLE PARK SA

3  1  3 

Contact Andrew Boswell for further details.

If you are looking for a property that needs your special stamp and updating then this is the one. In a fantastic location only a short walk to good local schools and the Aberfoyle Hub Shops, this original home offers a sound foundation and the quiet cul-de-sac location is a bonus.

Large L-shape lounge/meals with gas heater and wall a/c, three good sized bedrooms and all with built-in robes. Master with access to the two-way original bathroom. Rear family room overlooked by the original kitchen.

Spacious rear gardens with a big tool shed and fruit trees and offers so much in the way of potential for an addition of a nice big undercover entertaining area. Off street parking behind a roller door for at least two cars.

So bring an open mind and this one will respond

[For full version visit the website](https://www.magain.com.au)

**Type** : House  
**Building Size** : 13 sqm  
**Land Size** : 617 sqm  
**View** : <https://www.magain.com.au/property/43-idlewild-avenue-aberfoyle-park-sa/8436750>



**Andrew Boswell**  
08 8381 6000

Garden Shed

# 43 Idlewild Avenue, Aberfoyle Park

This drawing is for illustration purposes only.  
(Drawing is not to scale)

The drawing and the information contained is not intended to be part of any contract. All measurements are approximate and details intended to be relied upon should be independently verified.

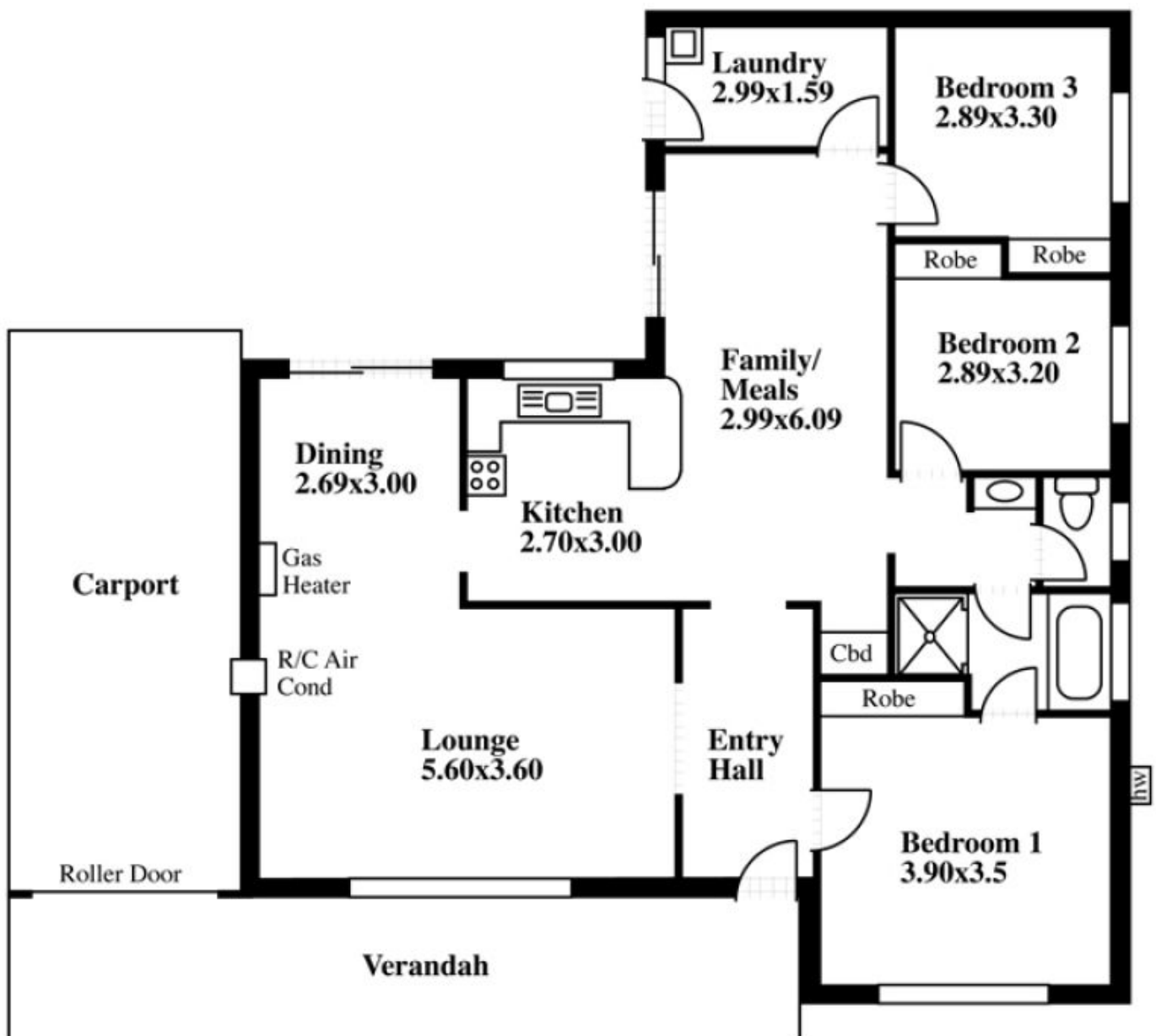

ESTIMATE OF LIVING AREA  
123.46 Square metres/ 13.27 Squares

Desk Top Image - (Y0513-64)