

MAGAIN



21 Pedro Avenue MORPHETT VALE SA

3 1 1

Situated in a quiet street, close by to local shopping & schools is this wonderful home fit for a growing family. It has been beautifully updated throughout and hosts a string of features, ready for the lucky new owners to move straight in & enjoy.

Offering three bedrooms, all with built in robes & ceiling fans, a large formal lounge room with reverse cycle heating & cooling and gas heating, a beautifully updated Alby Turner Kitchen featuring white moulded cabinetry, stainless steel appliances and a large walk in pantry with a ?eat in? style dining area.

Outside is a lovely heated in ground salt water pool with a paved area and an undercover entertaining area, making a

[For full version visit the website](#)

Type : House
Building Size : 12 sqm
Land Size : 683 sqm
View : <https://www.magain.com.au/property/21-pedro-avenue-morphett-vale-sa/8437106>



Zoe Ball
08 8381 6000

21 Pedro Avenue, Morphett Vale

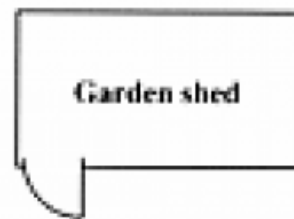
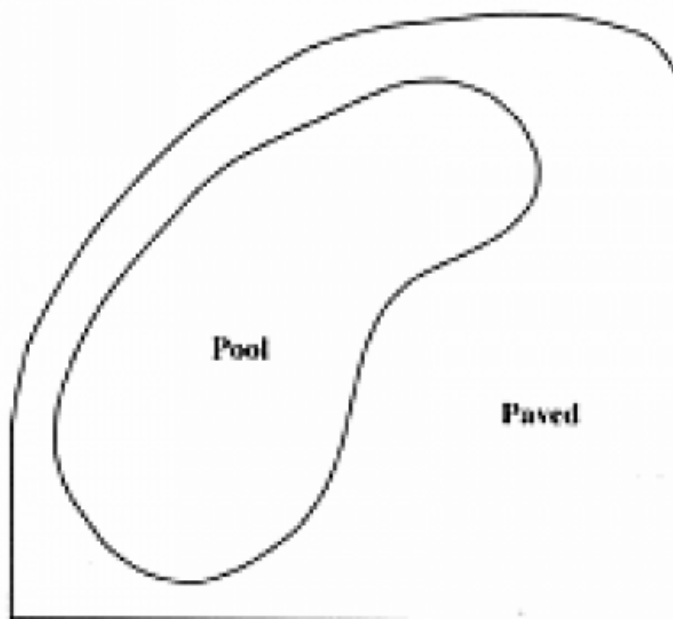

This drawing is for illustration purposes only.
(Drawing is not to scale)

The drawing and the information contained is not intended to be part of any contract. All measurements are approximate and details intended to be relied upon should be independently verified.

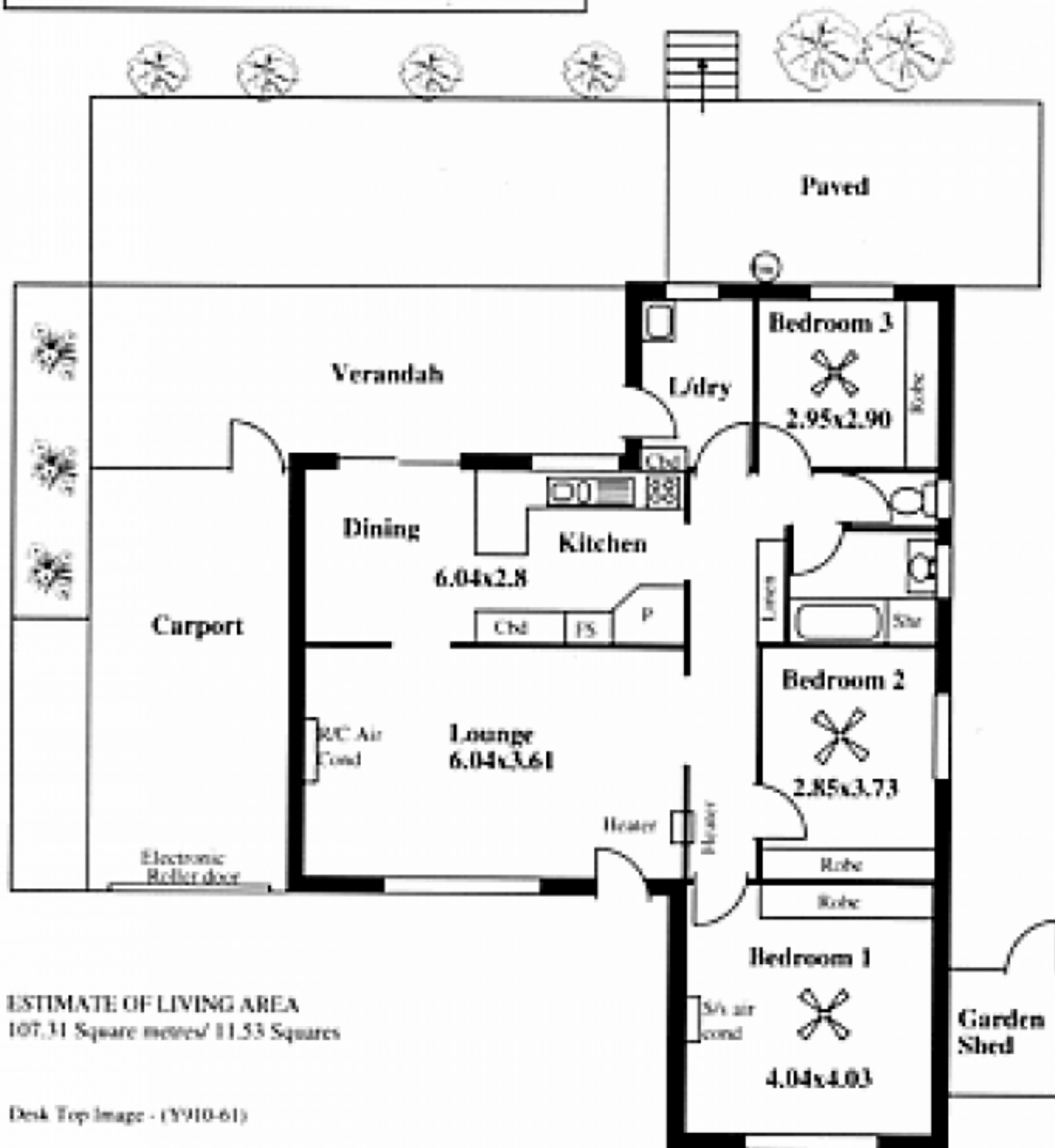

ESTIMATE OF LIVING AREA
107.31 Square metres/ 11.53 Squares

Desk Top Image - (Y910-61)