

# MAGAIN



16 Salisbury Avenue MORPHETT VALE SA

4 🛏 1 🚿 3 🚗

Call Scott for viewing times.

Calling all first home buyers & families looking for a big home with plenty of fantastic extras! Offering a floorplan featuring two living areas along with an external rumpus room, this home is a must see.

Upon entry, buyers will appreciate the functionally laid out floorplan consisting of a formal dining area & rear living area both with gas heaters along with four generous bedrooms; the master and 3rd bedroom with quality BIRs. The rooms are easily serviced by a neat bathroom, separate toilet and laundry with large linen cupboard.

Outside, the backyard has a lot to offer, with a rear patio

[For full version visit the website](https://www.magain.com.au/property/16-salisbury-avenue-morphett-vale-sa/8437236)

**Type** : House  
**Building Size** : 16 sqm  
**Land Size** : 640 sqm  
**View** : <https://www.magain.com.au/property/16-salisbury-avenue-morphett-vale-sa/8437236>



**Scott McPharlin**  
08 8382 0029

16 Salisbury Avenue Morphett Vale, South Australia.

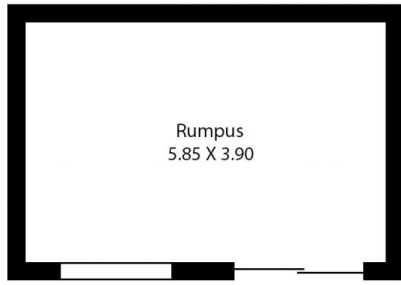

Picture intended as a reference only. Any specific measurements required should be obtained by an independent surveyor.