

# MAGAIN



## 14 Cranborne Crescent MORPHETT VALE SA

3 1 2

Please contact Mike Dobbin or Zoe Usher for inspection details.

Situated in this handy pocket in the heart of Morphett Vale this Boomerang style home is a perfect opportunity for first home buyers looking to buy their first home & get into the market or even a savvy investor looking for a solid investment. Close by to local shopping, schools and transport this home represents great value in today's market.

The functional floor plan offers three bedrooms, master with large built-in robes & period decorative cornices. The main bathroom is surprisingly large with a spacious shower and large vanity with dual sinks to help everyone get ready.

[For full version visit the website](https://www.magain.com.au/property/14-cranborne-crescent-morphett-vale-sa/8437270)

**Type** : House  
**Building Size** : 16 sqm  
**Land Size** : 690 sqm  
**View** : <https://www.magain.com.au/property/14-cranborne-crescent-morphett-vale-sa/8437270>



**Zoe Ball**  
08 8381 6000

14 Cranbourne Crescent Morphett Vale, South Australia.

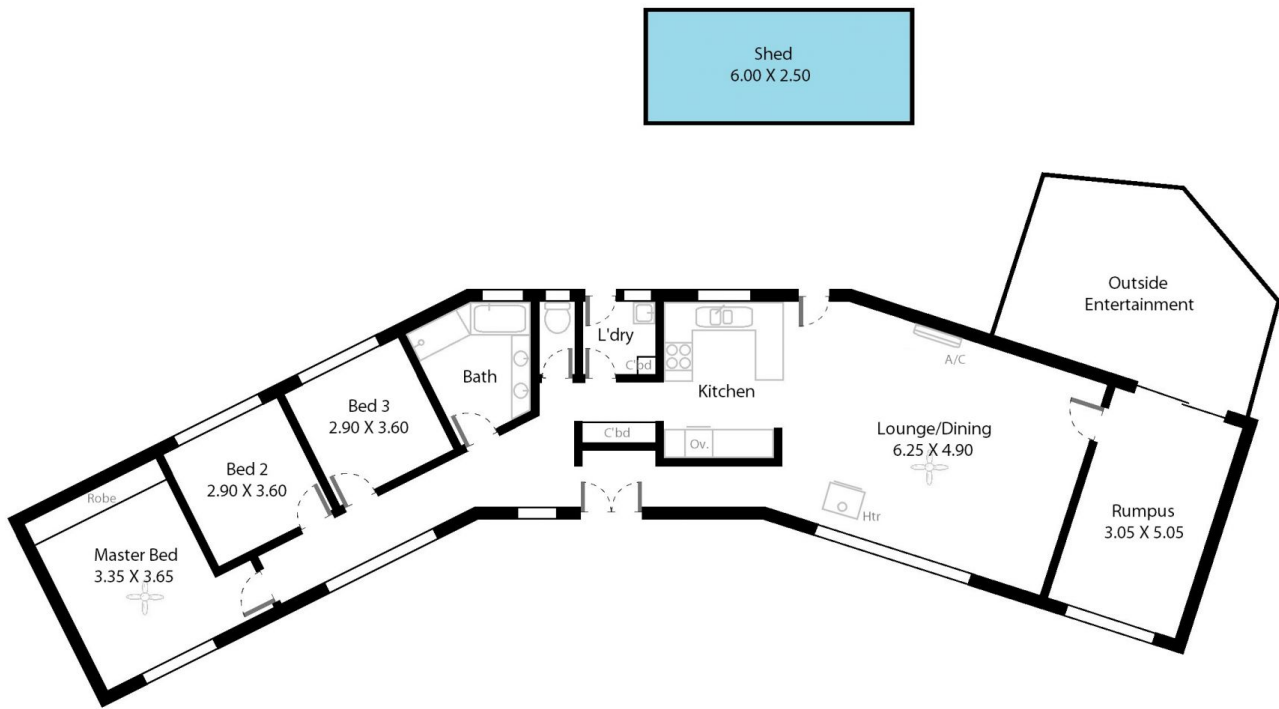

**Picture intended as a reference only.** Any specific measurements required should be obtained by an independent surveyor.