

MAGAIN



20 Daintree Drive SEAFORD RISE SA

4 2 2

Please contact Mike Dobbin or Zoe Usher for inspection details.

Set up for a growing family looking for their own space, this huge home is over 240sqm, with several separated living spaces there is plenty of room for everyone to have their own space, or come together as a family. There is also an abundance of off street parking, with a double carport plus drive through side access for parking a boat, caravan, other cars or even work vans or trailers for tradies.

This huge floor plan has been set up with three large bedrooms, all with ceiling fans, master with walk in robe & ensuite plus a huge third bedroom with its own dressing room. With an added stud wall, a fourth bedroom could

[For full version visit the website](#)

Type : House
Building Size : 26 sqm
Land Size : 600 sqm
View : <https://www.magain.com.au/property/20-daintree-drive-seaford-rise-sa/8437296>



Zoe Ball
08 8381 6000

20 Daintree Drive Seaford Rise, South Australia.

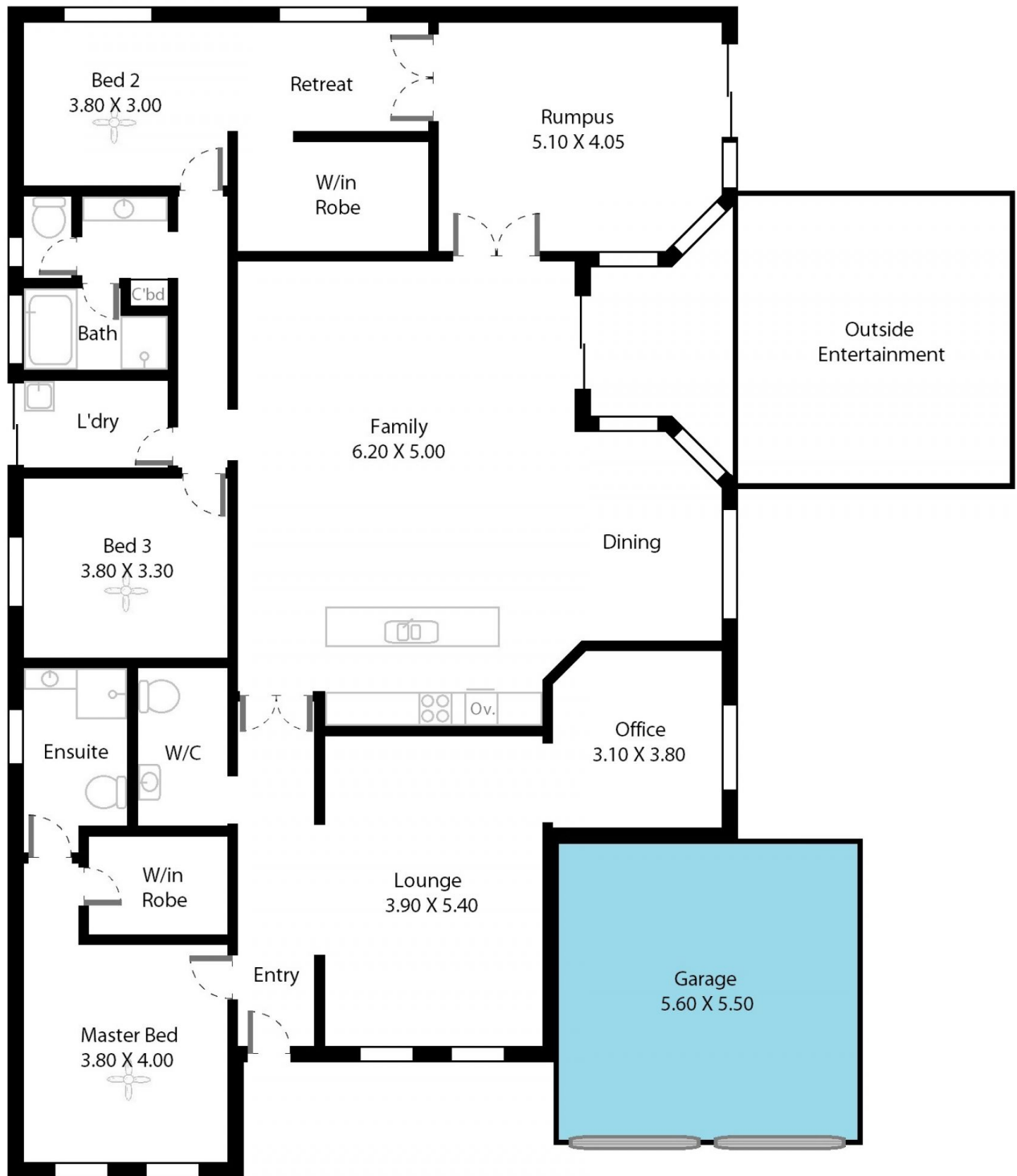

Picture intended as a reference only. Any specific measurements required should be obtained by an independent surveyor.