

MAGAIN



14 Bethany Court NOARLUNGA DOWNS SA

4  2  2 

This lovely home is simply made for families. With 4 bedrooms, a space to study, 2 bathrooms and a family friendly backyard it ticks all the boxes. Set in a quiet cul-de-sac there's a big reserve with a playground just one house away, and a walking trail that takes you to the nearby river for picturesque walks on summer evenings.

The main bedroom is quite separate from the others, providing peace and quiet in your own space. Completely luxurious in size, it's currently housing a king-sized bed with ease. A large glass sliding door provides a sensational view of the garden and there's a beautifully renovated ensuite with twin rain-heads in the shower.

Attractive timber floors are a practical feature throughout

[For full version visit the website](https://www.magain.com.au/property/14-bethany-court-noarlunga-downs-sa/8437383)

Type : House
Building Size : 17 sqm
Land Size : 916 sqm
View : <https://www.magain.com.au/property/14-bethany-court-noarlunga-downs-sa/8437383>



Scott McPharlin
08 8382 0029

BRICK STEPS
ON GARDEN

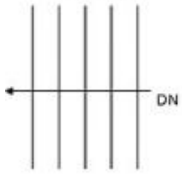

NOT IN ACTUAL LOCATION

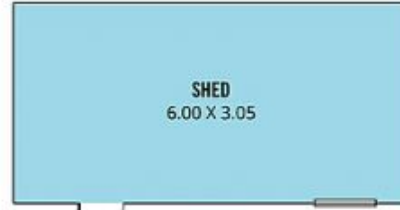

NOT IN ACTUAL LOCATION

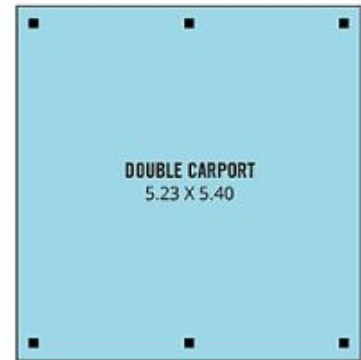

Scale in metres. This drawing is for illustration purposes only. All measurements are approximate and details intended to be relied upon should be independently verified.

Produced by The Fotobase Group