

# MAGAIN



We want to keep our beautiful state,  
and our vendors' homes safe.  
So please wear a mask at  
our open inspections.

**magain**  
REAL ESTATE



## 46 Jagger Crescent WOODCROFT SA

4 2 1

It's not often that you come across such a big and practical family home. With 5 excellent sized bedrooms, it offers plenty of room for the growing family. Two living areas, two bathrooms, plenty of storage and space to move both inside and outside makes this family home exceptionally functional.

A warm and inviting feeling throughout is achieved by a pleasant colour scheme, complemented with tasteful feature walls throughout. The slate tiling and timber floors in the living and high traffic areas offer both practicality and aesthetics. Carpet in the bedrooms provides warmth and comfort.

The kitchen has plenty of room to move and tons of

[For full version visit the website](https://www.magain.com.au/property/46-jagger-crescent-woodcroft-sa/8437488)

**Type** : House  
**Building Size** : 23 sqm  
**Land Size** : 669 sqm  
**View** : <https://www.magain.com.au/property/46-jagger-crescent-woodcroft-sa/8437488>



**Scott McPharlin**  
08 8382 0029

<https://www.magain.com.au>  
Magain Real Estate

Shop 15, Woodcroft Market Plaza, 217 Pimpala Road W  
08 8381 6000

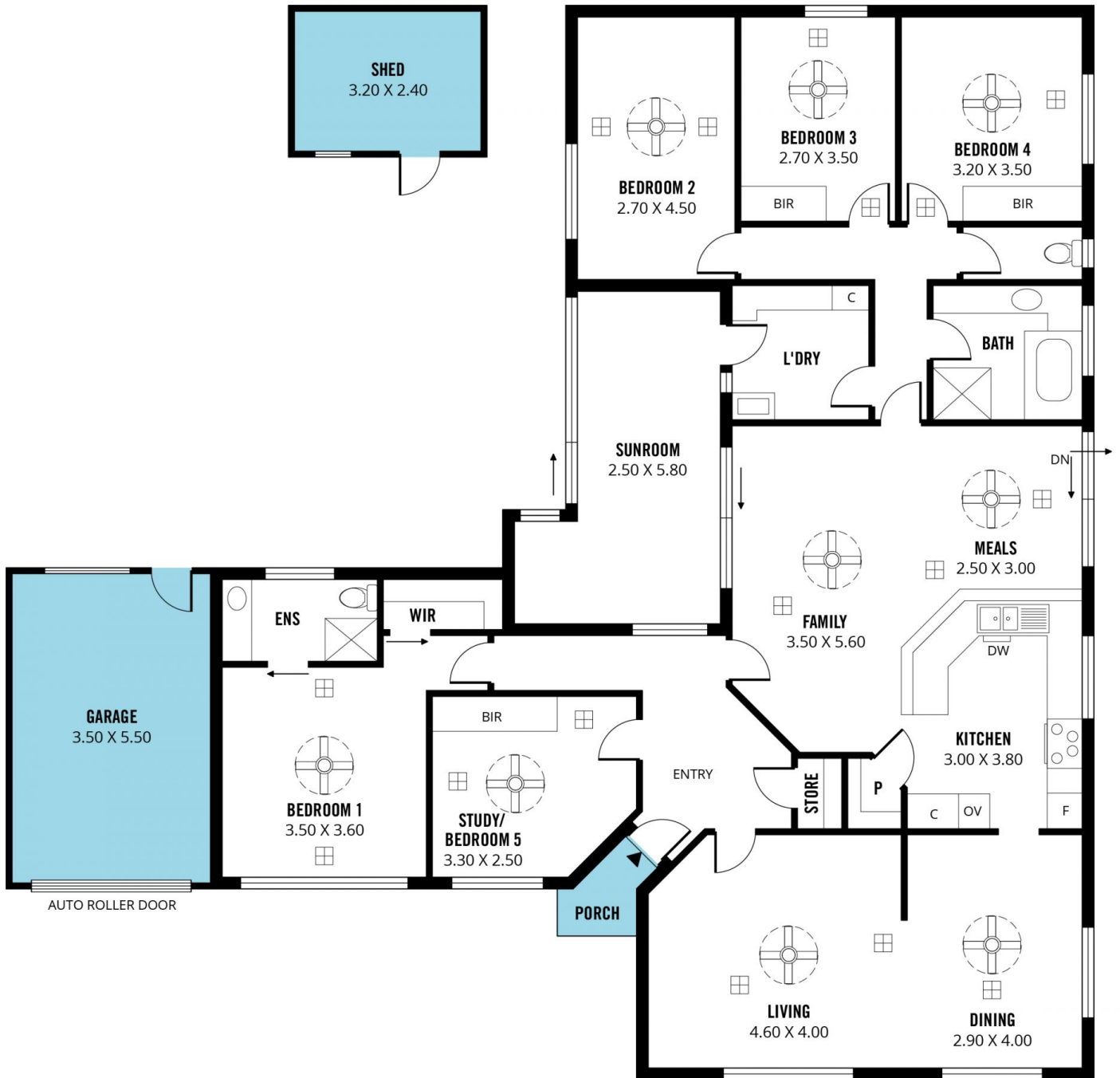

Scale in metres. This drawing is for illustration purposes only. All measurements are approximate and details intended to be relied upon should be independently verified.

Produced by **The Fotobase Group**