

MAGAIN

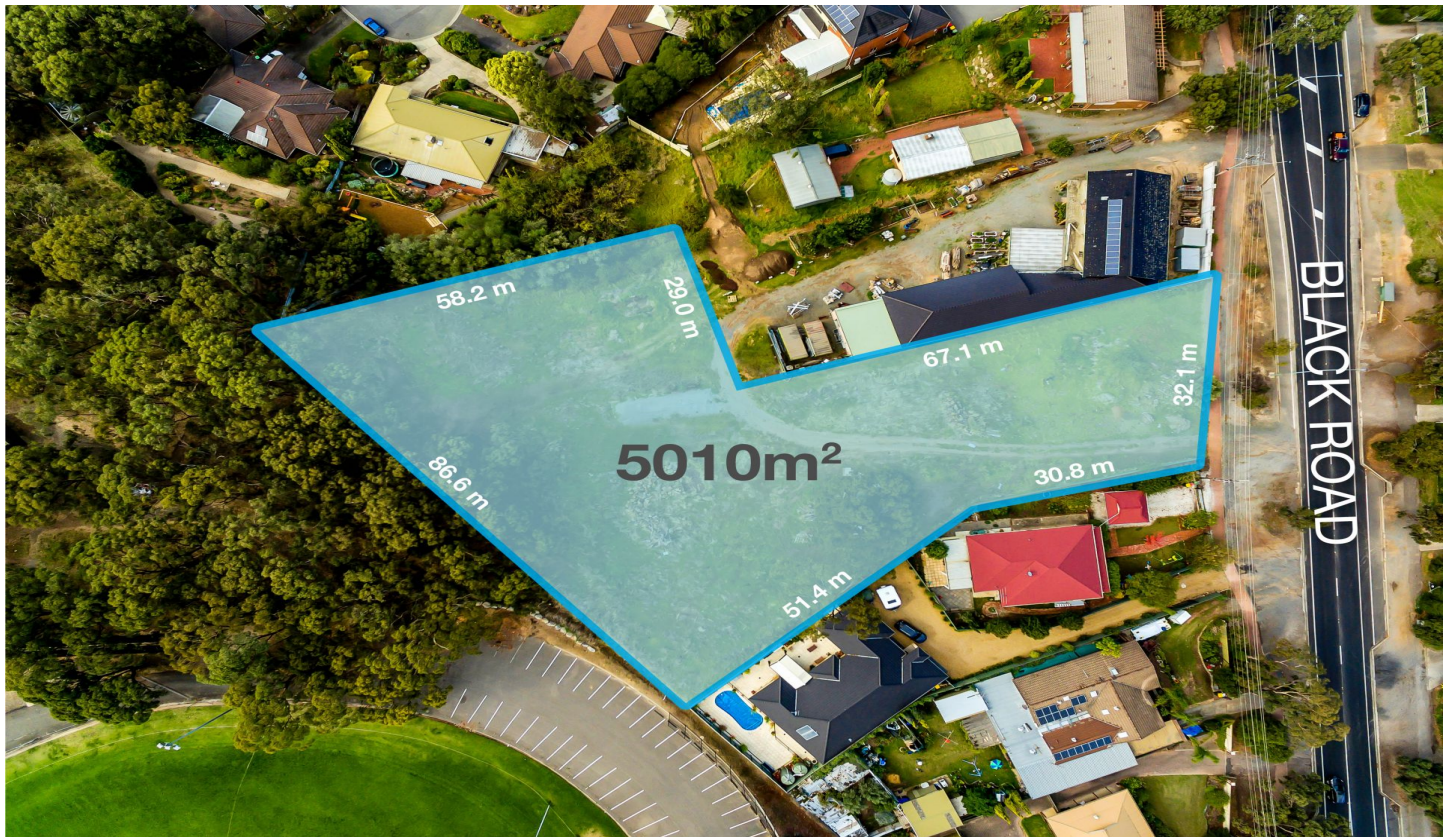

211 Black Road FLAGSTAFF HILL SA

Call Scott McPharlin for more information.

This substantial 5,010sqm (approx) land holding presents a very rare and exciting opportunity for developers! Zoned residential to the Onkaparinga Council with a frontage of 32metres, and backing on to a recreational ground, this land is positioned perfectly in the ever-popular leafy suburb of Flagstaff Hill.

With a functional site plan and most of the site level, this land lends itself to a community titled development or group dwellings (STCC). With surrounding amenities such as the Flagstaff Golf Club, Oval, Shopping Centre and a selection of fantastic schools along with close proximity to the city; newly constructed homes would prove to be very popular

Type : Land
Land Size : 5010 sqm
View : <https://www.magain.com.au/property/211-black-road-flagstaff-hill-sa/8437612>



Scott McPharlin
08 8382 0029

[For full version visit the website](https://www.magain.com.au)

<https://www.magain.com.au>
Magain Real Estate

Shop 15, Woodcroft Market Plaza, 217 Pimpala Road W
08 8381 6000