

MAGAIN



12 Watts Court Reynella East SA

4 2 3

What a great family home. Set in a quiet cul-de-sac within a short walking distance to Reynella East School, this home is certainly set up for families. With 4 bedrooms, a spacious lounge, study nook and second living area there's plenty of room inside. The yard is great with a large undercover entertaining area and plenty of simple lawn area for the trampoline and family pets. A huge, fully lined rumpus room out the back seals the deal. Previously used as a photography studio this would make a sensational gym, man cave, or office.

Not only practical, this home is also easy on the eye with fresh paint and brand new flooring throughout. A sophisticated bathroom upgrade along with a fresh white kitchen with stainless appliances means there's nothing to

[For full version visit the website](https://www.magain.com.au/property/12-watts-court-reynella-east-sa/8437878)

Type : House
Price : \$ 685,000
Building Size : 146 sqm
Land Size : 694 sqm
View : <https://www.magain.com.au/property/12-watts-court-reynella-east-sa/8437878>



Scott McPharlin
08 8382 0029

<https://www.magain.com.au>
Magain Real Estate

Shop 15, Woodcroft Market Plaza, 217 Pimpala Road W
08 8381 6000

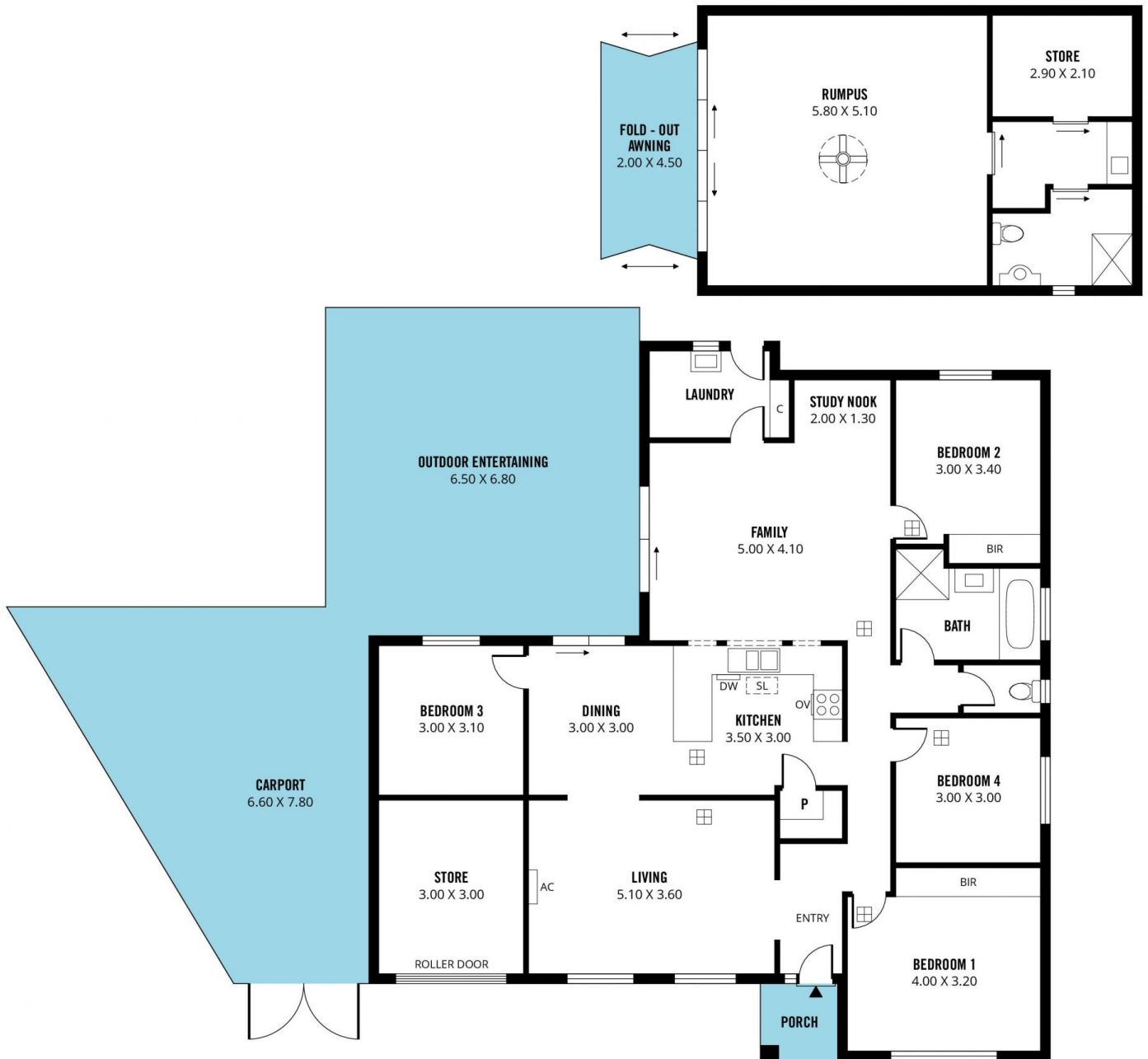

Scale in metres. This drawing is for illustration purposes only. All measurements are approximate and details intended to be relied upon should be independently verified.

Produced by The Fotobase Group