

# MAGAIN

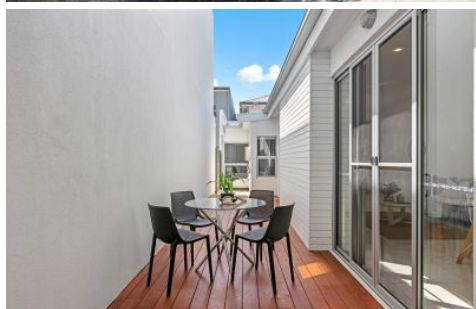

## 22 Patta Avenue Lightsview SA

3 2 1

Please contact Sam Raven for inspection details.

Completed in spectacular style, this 2017 built home offers modern styling and fantastic features along with spacious living & a wonderful timber decked entertaining area. With new build times stretching out more & more this is the perfect opportunity to secure a beautifully finished quality home and be able to move in straight away, and without the hassles of building. Located in the heart of vibrant Lightsview, offering walking distance to local lakes, reserves and cafes and only 8km to the CBD.

Split over two levels this home offers three bedrooms, the

[For full version visit the website](https://www.magain.com.au/property/22-patta-avenue-lightsview-sa/8437879)

**Type** : House  
**Price** : \$ 591,000  
**Building Size** : 160 sqm  
**Land Size** : 171 sqm  
**View** : <https://www.magain.com.au/property/22-patta-avenue-lightsview-sa/8437879>



**Sam Raven**  
08 8381 6000



**Zoe Ball**  
08 8381 6000

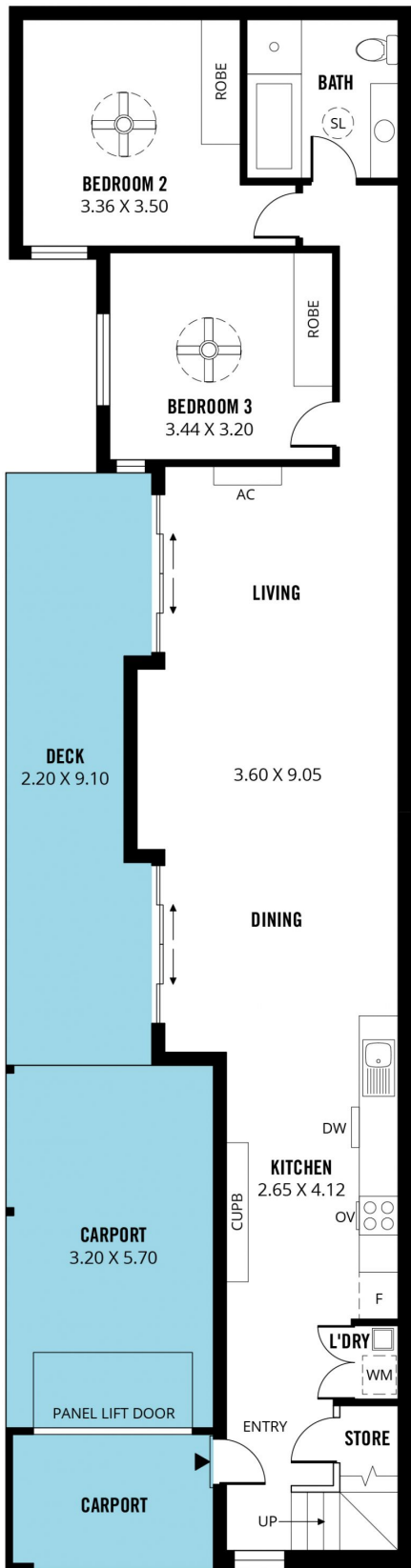

**GROUND FLOOR**

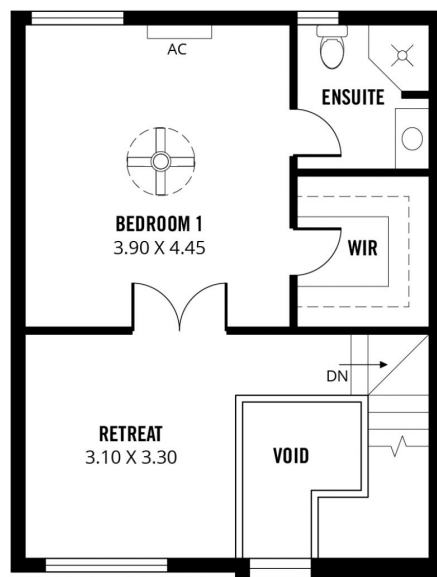

**UPPER FLOOR**

