

MAGAIN



32 Simone Crescent Morphett Vale SA

3 1 1

Tucked away at the end of a court, this beautifully presented home is sure to please and be very appealing to a range of buyers. This neat & complete three bedroom home offers a low maintenance block while not compromising on space or quality. There are plenty of added extras too including a fantastic entertaining area, security roller shutters and a lockup garage with drive through access.

The spacious floor plan offers three bedrooms, all with built in robes, plus ensuite access to the two way bathroom which also has a separate toilet for convenience and linen cupboard. Down the hallway is the open plan living area, complete with a gas space heater and carpeted floors, dining area that overlooks the backyard through large light

[For full version visit the website](#)

Type : House
Price : \$ 543,000
Building Size : 103 sqm
Land Size : 434 sqm
View : <https://www.magain.com.au/property/32-simone-crescent-morphett-vale-sa/8437922>



Zoe Ball
08 8381 6000

<https://www.magain.com.au>
Magain Real Estate

Shop 15, Woodcroft Market Plaza, 217 Pimpala Road W
08 8381 6000

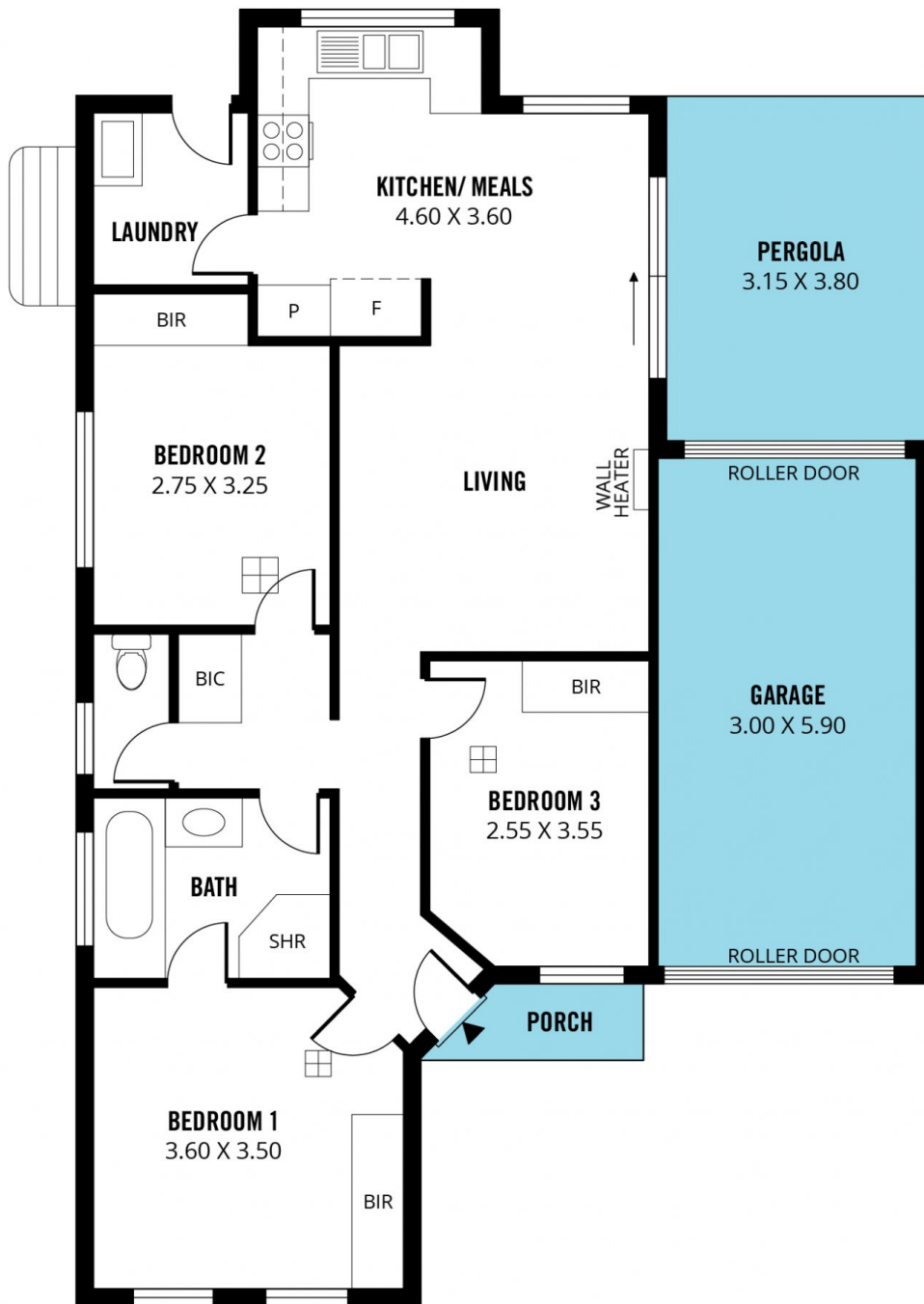

Scale in metres. This drawing is for illustration purposes only. All measurements are approximate and details intended to be relied upon should be independently verified. Produced by **The Fotobase Group**