

# MAGAIN



2 Mitchell Avenue Murray Bridge East SA

4 1 5

Please contact Scott McPharlin from Magain Real Estate for all your property advice.

This home offers plenty of space, both inside and out. Set on a block of around 6,300m<sup>2</sup> it consists of 4 big bedrooms, two living areas, a central kitchen and bathroom with full sized bath, separate toilet and separate laundry. Light neutral colours throughout and slate floors make it pleasant and homely.

The basic neutral kitchen overlooks the meals area. Great for families it comes complete with a gas cooktop and dishwasher. A big split system and combustion heater in the living area will keep you comfortable all year round. Verandahs on all sides of the home provide protection from

[For full version visit the website](https://www.magain.com.au)

**Type** : House  
**Price** : \$ 424,000  
**Building Size** : 138 sqm  
**Land Size** : 6328 sqm  
**View** : <https://www.magain.com.au/property/2-mitchell-avenue-murray-bridge-east-sa/8438076>



**Scott McPharlin**  
08 8381 6000

<https://www.magain.com.au>  
Magain Real Estate

Shop 15, Woodcroft Market Plaza, 217 Pimpala Road W  
08 8381 6000



(NOT IN POSITION)

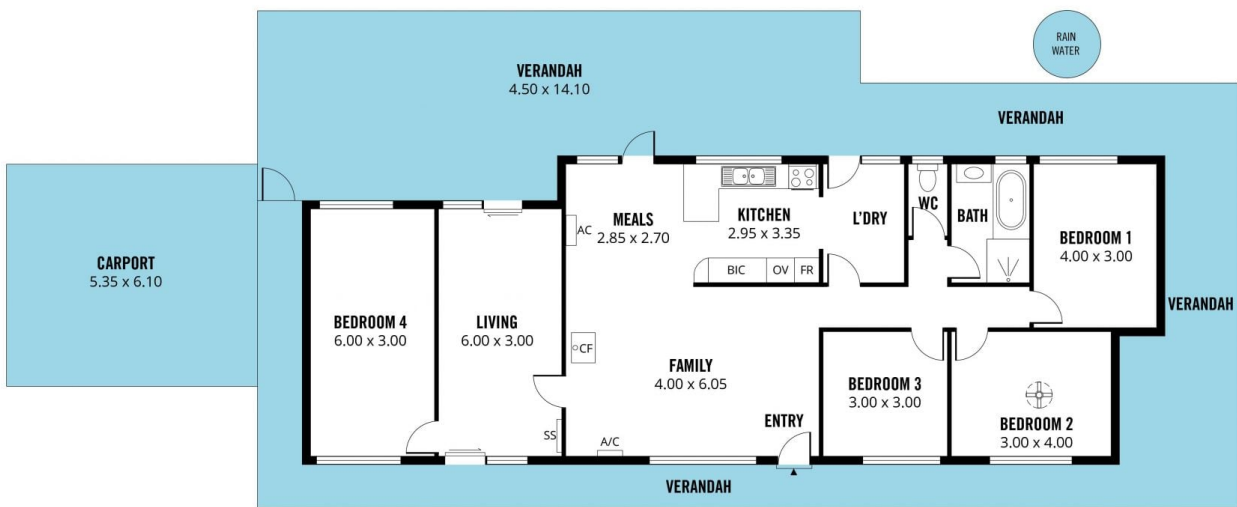

Scale in metres. This drawing is for illustration purposes only. All measurements are approximate and details intended to be relied upon should be independently verified.

Produced by **The Fotobase Group**