

# MAGAIN



## 18 Riddoch Crescent Woodcroft SA

4  2  2 

Please contact Karen Heuer or Andrew Boswell from Magain Real Estate for all your property advice.

Situated on a spacious 853 sqm allotment, this much-loved home exudes charm and functionality. A neat and tidy facade welcomes you into a generously proportioned interior. The spacious entrance hall leads to a delightful lounge with garden views and a master bedroom boasting a bay window, luxurious renovated ensuite with his and hers basins and walk-in robe.

The heart of the home is a chef's dream with an impressive kitchen featuring quality appliances, a 900 mm gas stove top, two ovens, beautiful benchtops and sleek cabinetry. There is also a generous sized butler's pantry. Modern

[For full version visit the website](https://www.magain.com.au/property/18-riddoch-crescent-woodcroft-sa/8438090)

**Type** : House  
**Price** : \$ 950,000  
**Building Size** : 196 sqm  
**Land Size** : 853 sqm  
**View** : <https://www.magain.com.au/property/18-riddoch-crescent-woodcroft-sa/8438090>



**Karen Heuer**  
08 8381 6000



**Andrew Boswell**  
08 8381 6000

<https://www.magain.com.au>  
Magain Real Estate

Shop 15, Woodcroft Market Plaza, 217 Pimpala Road W  
08 8381 6000

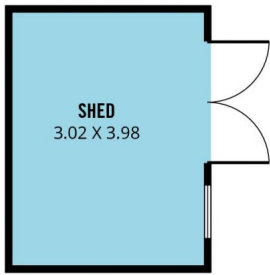

APPROX. LOCATION

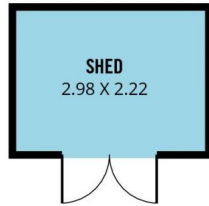

APPROX. LOCATION

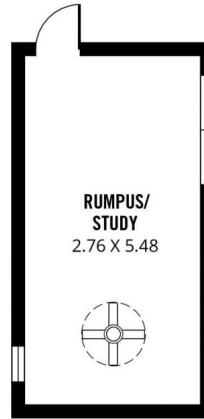

NOT IN POSITION

