

MAGAIN



2/833 Marion Road Mitchell Park SA

2 **1** **1**

Please Contact Zoe Ball from Magain Real Estate for all your property advice

Perfectly positioned in the heart of Mitchell Park, this well maintained 2 bedroom unit offers comfort, convenience, and contemporary living - ideal for first home buyers, downsizers, or savvy investors.

Step inside and be impressed by the well-sized open living and dining area, complemented by floating floorboards that add warmth and style to the space. The seamless flow leads into a newly renovated kitchen, complete with a gas cooktop, electric oven and dishwasher - a modern and functional hub for any home cook.

[For full version visit the website](https://www.magain.com.au/property/2833-marion-road-mitchell-park-sa/8438398)

Type : Unit
Price : \$ 506,000
Building Size : 63 sqm
Land Size : 65 sqm
View : <https://www.magain.com.au/property/2833-marion-road-mitchell-park-sa/8438398>



Zoe Ball
08 8381 6000



Sam Raven
08 8381 6000

<https://www.magain.com.au>
Magain Real Estate

Shop 15, Woodcroft Market Plaza, 217 Pimpala Road W
08 8381 6000

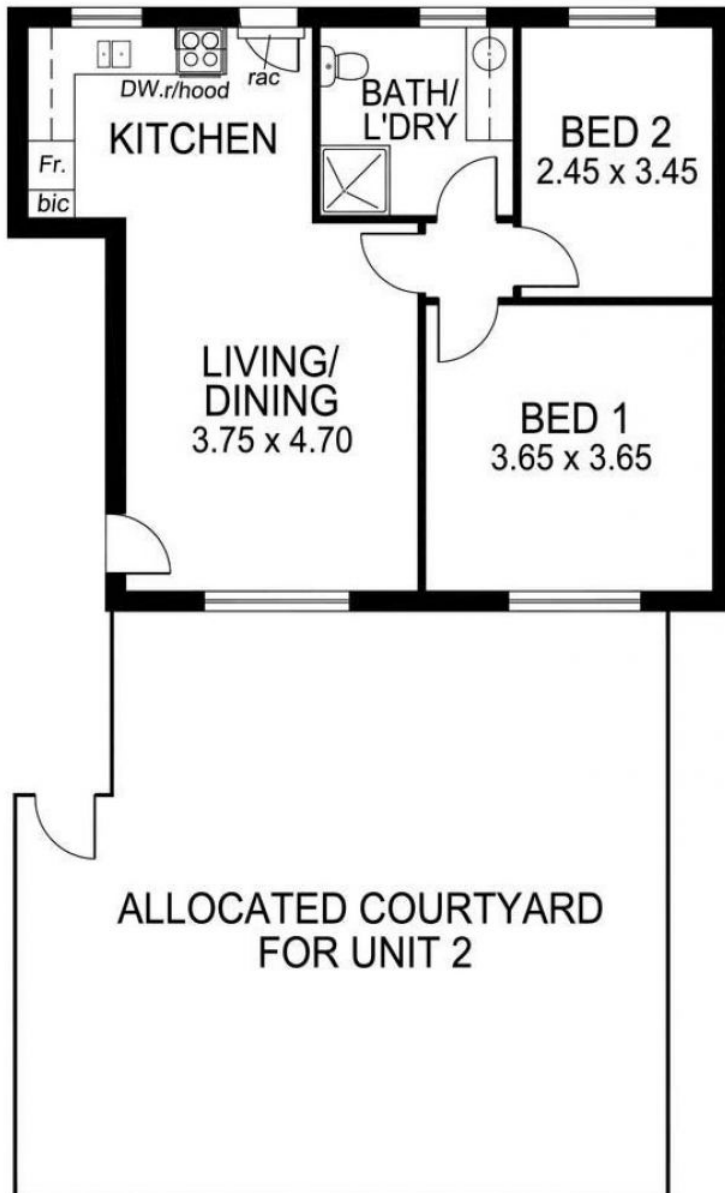
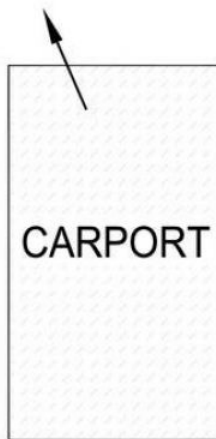

TOTAL AREA:	63.73m ² /6.85sqs
(Estimate only)	

This drawing is for illustration purposes only.
All measurements are approximate only and information
intended to be relied upon should be independently verified.