

MAGAIN



302/160 Grote Street Adelaide SA

1 1

Secure your place in one of Adelaide's most sought-after addresses - the iconic Grand Central Tower - and embrace a lifestyle that truly has it all. Positioned just a leisurely stroll from the vibrant Adelaide Central Market, Chinatown District, and the restaurant-lined energy of Gouger Street, this is inner-city living at its absolute finest.

Whether you're a first-home buyer, downsizer, or savvy investor, this is a rare opportunity to own a piece of Adelaide's premier urban lifestyle without compromise.

Resort-Style Building Amenities - Included, No Memberships Required

What sets Grand Central Tower apart is its extraordinary collection of resident-exclusive facilities - all included at no extra cost:

Type : Apartment
Price : \$399k - \$438k
Building Size : 62 sqm
View : <https://www.magain.com.au/property/302160-grote-street-adelaide-sa/8715592>



Sam Raven
08 8381 6000



Baz Rampal
08 8381 6000

[For full version visit the website](https://www.magain.com.au)

<https://www.magain.com.au>
Magain Real Estate

Shop 15, Woodcroft Market Plaza, 217 Pimpala Road W
08 8381 6000

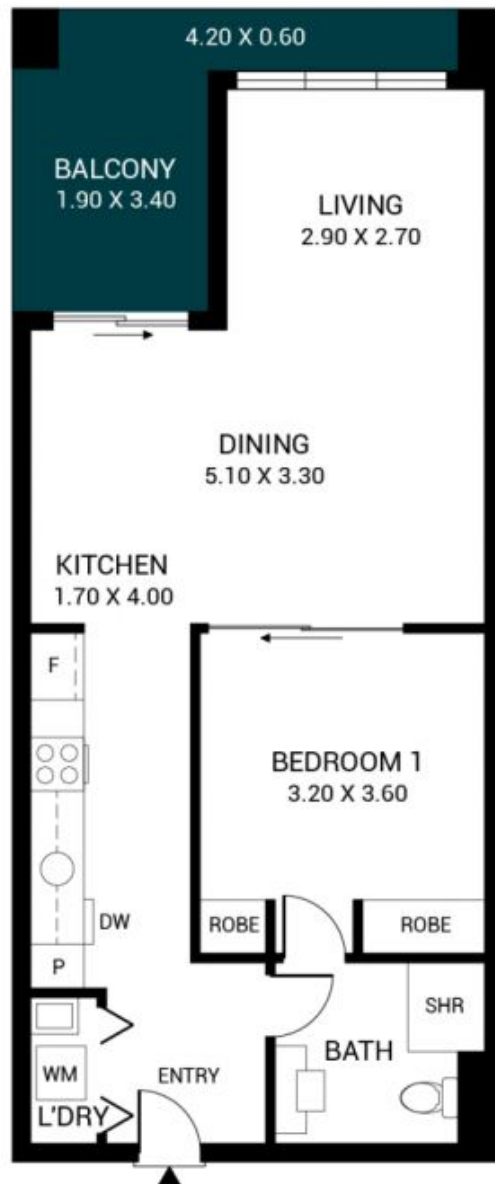

Scale in metres. This drawing is for illustration purposes only. All measurements are approximate and details intended to be relied upon should be independently verified. Produced by **The Fotobase Group**